

## Applications:

- Verification and validation
- Presence/Absence
- Identification methods
- ISO 17025 laboratories requiring Certified Reference Material (CRM)

## Package Details:

- One KWIK-STIK™: User-friendly design with a lyophilized microorganism pellet, ampoule of hydrating fluid and inoculating swab
- Certificate of Analysis
- Instructions for Use

## Highlights:

- Qualitative QC microorganisms just one passage from the reference strains for ultimate authenticity
- For Testing Laboratories, Section 5.6.3.2 of ISO 17025 states: "Reference materials shall, where possible, be traceable to SI units of measurements, or to Certified Reference Materials."
- Ready-to-use format saves you time and money
- Refrigerated storage is easy and economical
- Traceability to reference cultures ensures authenticity
- Technical Support experts available for guidance

# How to Use Lab-Elite™ CRM

1

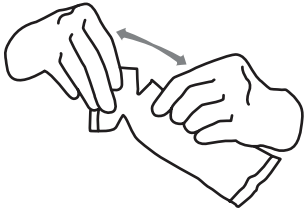

Allow the unopened Lab-Elite™ (KWIK-STIK™) pouch to equilibrate to room temperature. Tear open pouch at notch and remove the KWIK-STIK unit.

2

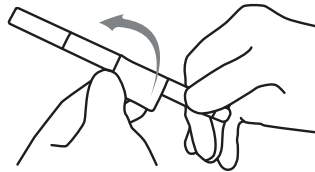

Tear off pull-tab portion on the label and attach it to the primary culture plate or QC record. Do not disassemble the device during hydration.

3

Over the edge of the work bench or counter, crack the ampoule at the top of the KWIK-STK (just below the fluid meniscus of the ampoule) found in the cap to release the hydrating fluid.

4

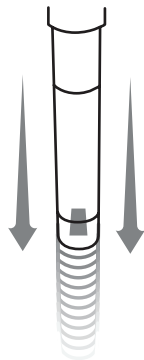

Hold vertically and tap on a hard surface to facilitate flow of the fluid through the shaft into the bottom of unit where the pellet is contained.

5



Using a pinching action on the bottom portion of the unit, crush the pellet in the fluid until the pellet suspension is homogenous.

6

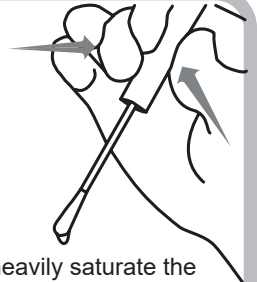

Immediately heavily saturate the swab with the hydrated material and transfer to the appropriate agar medium, or use according to the laboratory's SOP.

7

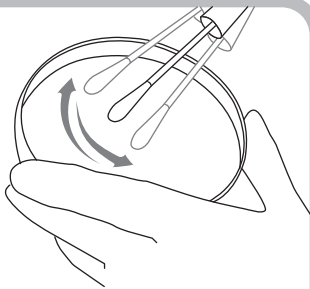

Inoculate the primary culture plate(s) by gently rolling the swab over one-third of the plate.

8

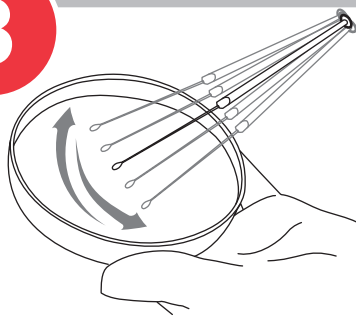

Using a sterile loop, streak to facilitate colony isolation.

9

Using proper biohazard disposal, discard the KWIK-STIK.



10

Immediately incubate the inverted inoculated primary culture plate(s) at temperature and conditions appropriate to the microorganism.

*Culture method can be found on the product's page at [microbiologics.com](http://microbiologics.com)*